

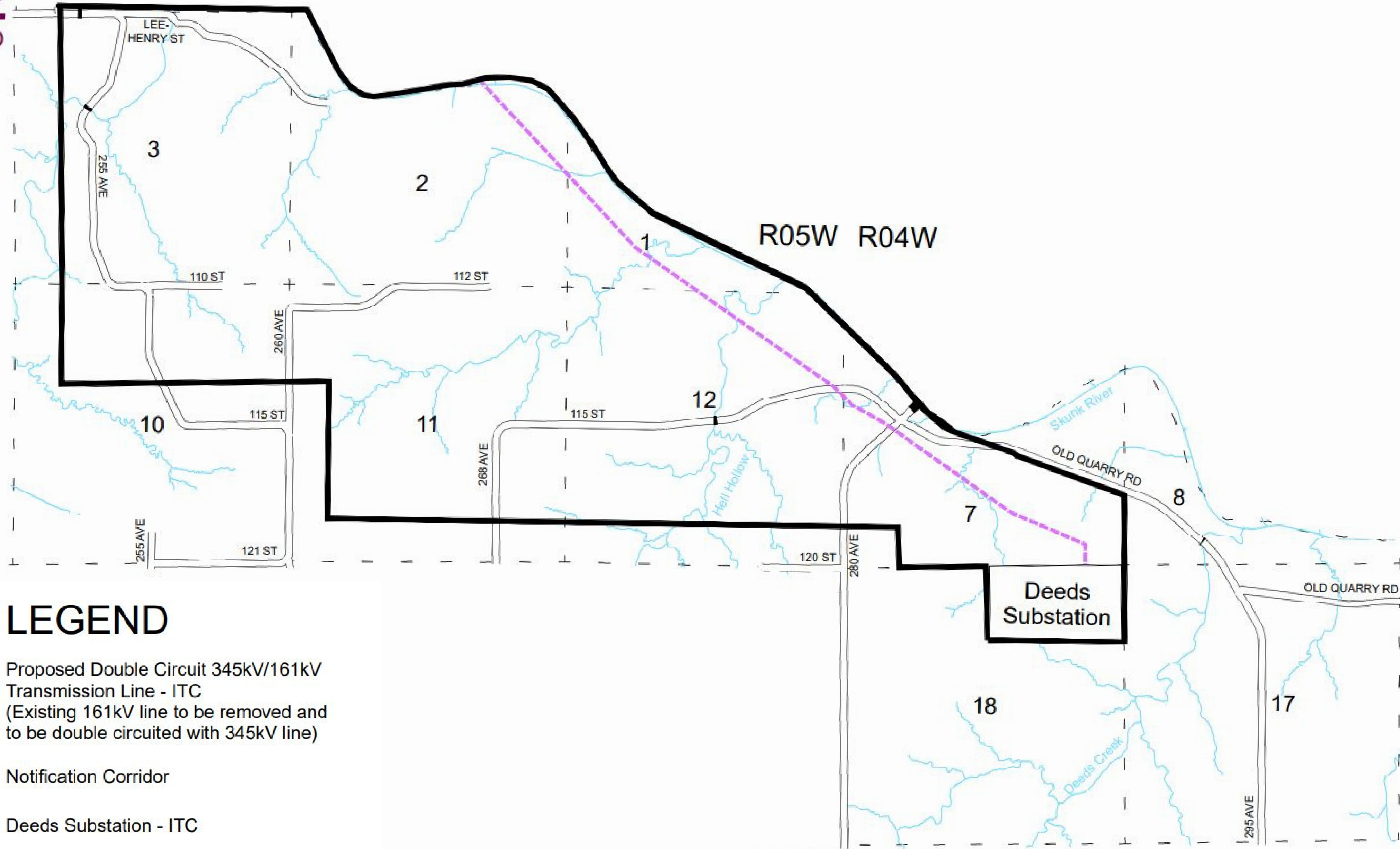

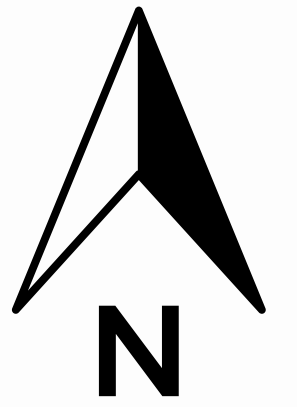



HENRY CO

LEE CO

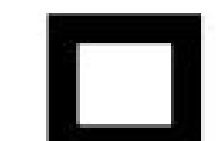
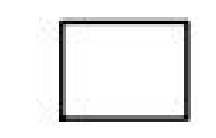

LEGEND

-  Proposed Double Circuit 345kV/161kV Transmission Line - ITC
(Existing 161kV line to be removed and to be double circuited with 345kV line)
-  Notification Corridor
-  Deeds Substation - ITC
-  Section Line
-  Hydrology
-  Bridges
-  Roads



Deeds - Skunk River
Proposed 345kV Electric Transmission Line
Lee County, IA

Not to Scale
 Date: 10/9/2023
 Drawing No: Notification Corridor
 Page: 1 of 1